

Ballet CN 430S B+
Instruction Manual

Please download and install “HA-Fit” APP first.



CWarning	03
Product parameter	04
Packing list	05
Product graphic	06
Power on/off	07
Product charging	08
Multi-function keys	10
Bluetooth function	11
Replace earplugs	12
Wearing a method	14
HA-Fit APP	15
Care and maintenance	19

Replace the leaf cover	20
Daily maintenance and maintenance	21
Fault self-check table	22
Contraindications and precautions	23
Working condition	25
Transportation & storage conditions	25
Disclaimer	25
Important note	26

Warning

Hearing aids are devices for people with hearing loss. They are customized and fitted according to personal hearing conditions and listening habits. Therefore, it is not suitable for other people to use. Read this instruction carefully before using your hearing aid and follow its instructions. Improper operation may damage your hearing aid.

Product parameter

Max. OSPL90	110±4dB
HF Avg.OSPL90	106± 4dB
Max gain	40±5dB
HFA Gain	35±5dB
Noise Level	≤32dB
Frequency Range	F1≤200Hz F2≥5000Hz
Battery Current	≤3%
Total Distort	NA

	Hearing aid	Charging box
Charging Time	≤2H	≤2H
Endurance time	Hearing aid mode: ≥ 26H Audio mode: ≥ 5H	About 3 times

Packing list

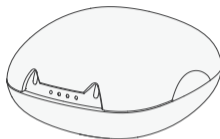

Charging box

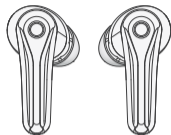

Hearing aid



Earplug



Cleaning brush



Cerumen kit

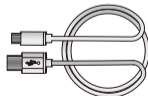

Charging cable



Specification

Product graphic

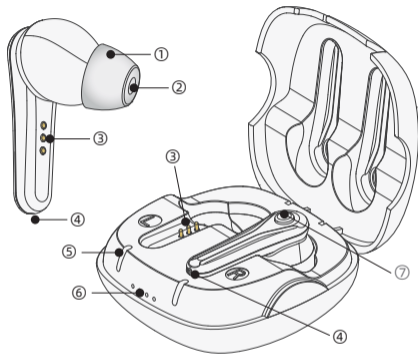

- ① Earplug
- ② Sound holes
- ③ Charging contacts
- ④ Microphone
- ⑤ Hearing aid charging indicator
- ⑥ Charging case charging indicator
- ⑦ Multi-function keys

Power on/off

1. Power on

- Take the hearing aid out of the charging case and the hearing aid will automatically turn on.
- Long press the multi-function button 35 hearing aid to turn on

2. Power off

- Put the hearing aid into the charging case, and the hearing aid will automatically turn off
- Long press the multi-function button 6s hearing aid to turn off

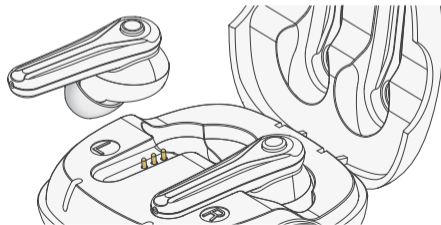

Product charging

1. Hearing aid charging

· When you hear the "low_battery" prompt tone when wearing hearing aids, the surface hearing aid is low in power, please charge it in time; Place the hearing aid into the charging box. The hearing aid will automatically start charging. You can confirm whether the charging is complete according to the hearing aid charging indicator.

Charging condition	Light condition
In charge	The white lamp is long bright
Charge completion	The lights go out

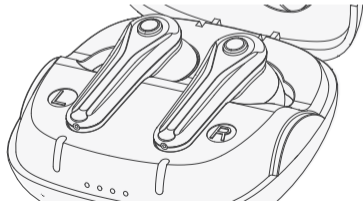

Charging box charging

· The charging box has the power storage function and can charge the hearing aid. When the case runs out of power, it can be connected to a power source to charge the hearing aid and the case. The charging case has 4 indicators, and each light that lights up during charging means 25% full charge.

Indicator status	Battery capacity of charging box
☼ ⊗ ⊗ ⊗	0-25%
☼ ☼ ⊗ ⊗	26-50%
☼ ☼ ☼ ⊗	51-75%
☼ ☼ ☼ ☼	75-100%

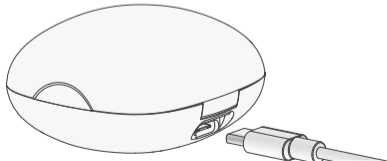

Multi-function keys

According to press the hearing aid multifunctional key time can achieve different functions.

Press mode	Function
Short press	Adjust the volume
Long press for 2S	Mode switching
Long press for 3S	Power on
Long press for 6S	Power off
Long press for 10S	Bluetooth reset function

Introduction to hearing aid mode

There are three programs inside hearing aids that can be switched by pressing a button.

A prompt sound	Mode
"beep"	General Hearing Mode
"beep beep"	Noise reduction mode 1
"beep beep beep"	Noise reduction mode 2

Bluetooth function

Hearing aids come with a Bluetooth feature that connects to a Bluetooth device to receive audio.

Pairing method

- Step 1: Make sure the hearing aid is just turned on and the Bluetooth of the smart device is turned on.
- Step 2: Open the Bluetooth list of smart devices, search "Ballet" for pairing, and you will hear "connected" when the connection is successful.

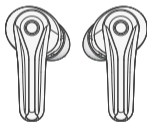

Note:

- The Bluetooth function of the hearing aid will automatically turn off if the Bluetooth is not connected for a long time.
- Automatic pairing without re-pairing after the first connection

Replace earplugs

In order to make users have a better wearing experience, we will give away 3 pairs of earplugs of different sizes. You can try replacing earplugs when problems such as swelling of the ear canal and loud hearing aids occur.

1. Pinch the body of the hearing aid with one hand and remove the inappropriate earplugs with the other hand.

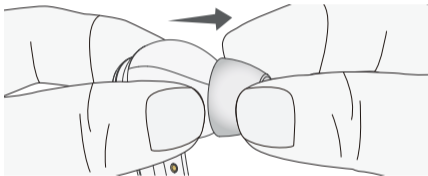

2. Choose your size from the available earplugs.



3. Insert the appropriate earplugs into the sound hole of the hearing aid to ensure that they are securely installed.

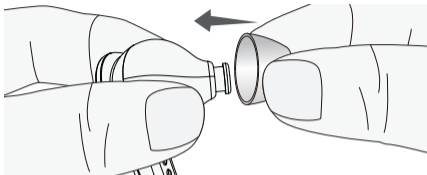

Wearing a method

1. Pinch the hearing aid with your thumb and index finger, and place the earplug side in the ear canal, insert the hearing aid into the ear canal comfortably.

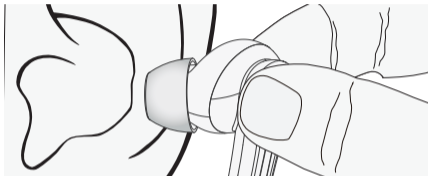

2. Fine-tune the hearing aid position to adjust the hearing aid to a comfortable position.



HA-Fit APP

Please download and install "HA-Fit" APP first.

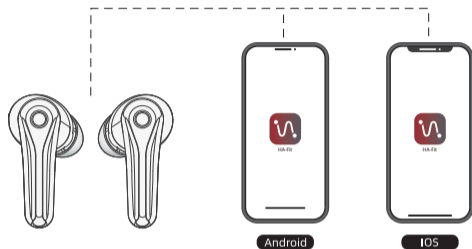

1.Connect APP

Step 1: Turn on your hearing aid.

Step 2: Turn on Bluetooth.

Step 3: Open the HA-Fit APP.

Step 4: Click the "Search Device" button.

After "searching for devices", the HA-Fit APP will automatically connect to the hearing aid, and the successful connection status is shown in the figure.



2. Hearing assessment

With the Hearing Hearing Evaluation module, you can quickly set up your hearing aids according to your hearing characteristics.

Step 1: Put on your hearing aid and turn it on.

Step 2: Please do the assessment in a quiet place.

Step 3: Click the "Listening Evaluation" button.

Step 4: Follow the prompts to complete your personal listening assessment.

Step 5: After completing your hearing evaluation, click the Auto-Optimize button and your hearing aids will be optimized based on your hearing score.

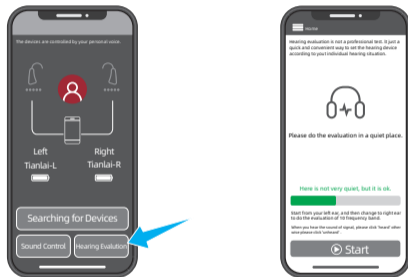

3.Sound control

The HA-Fit app lets you easily control your hearing aid on your Android or Apple device; The HA-Fit application covers key functions such as changing program, volume, and so on.

Step 1: Click the “Sound Control” button.

Step 2: Enter the sound control interface, you can easily control the hearing aids, you can adjust various parameters, volume, program, frequency band, noise reduction...



Care and maintenance

This hearing aid is a very complex system. Regular cleaning and maintenance of hearing aids, can protect the health of hearing aids and users.

1. Periodically clean the sound inlet with a cleaning brush.



2. Clean the sound outlet regularly with a cleaning brush.

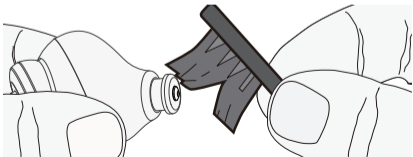

Replace the leaf cover

Cerumen filter which can effectively prevent cerumen into cause damage to hearing aids, hearing aids filter need to be replaced every once in a while.

1. Remove the earplugs, insert the filter removal tip into the hearing aid's sound hole, and pull out the old filter.

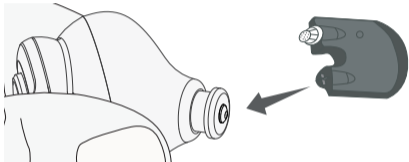

2. Insert the new filter hole of hearing aids, after confirm the card tight discarding the old filter.

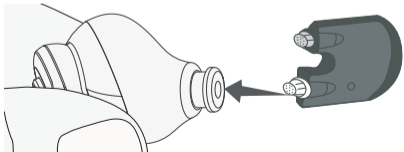

Daily maintenance and maintenance

Hearing aids are sophisticated and sensitive electronic equipment, so pay special attention to the daily maintenance of hearing aids:

- When cleaning, please use a soft dry cloth or tissue paper to wipe the grease or moisture off the hearing aid shell. Do not use household cleaning products (washing liquid, laundry detergent, soap, etc.) to clean your hearing aid.
- Remove the earwax mesh cover frequently, clean it with a small dry brush, and replace it if necessary. Please consult an auditor for specific replacement methods.
- Do not place hearing aids in the hot sun, near furnaces or other heat sources.
- Do not use hearing aids in showers, swimming, in rainy environments, or in environments with high humidity .
- Carefully protect the hearing aid from falling onto the ground or other hard surfaces.
- Avoid contact with chemicals or strong cleaners.

Fault self-check table

Malfunction	Treatment method
Sound is distorted	<ol style="list-style-type: none">① Decrease volume.② Charge the product.③ Clean the dome.
The product emits whistling sounds	<ol style="list-style-type: none">① Reinsert the Earplugs until it fits tightly.② Decrease volume.③ Clean the Earplugs.
The product does not work	<ol style="list-style-type: none">① Change to different size of Earplugs.② Check whether the microphone is damaged or not.③ Charge the product.
Can't charge	<ol style="list-style-type: none">① Clean the charging contacts.② Make sure that the charging contacts are in good contact.

Contraindications and precautions

Hearing aids are sophisticated and sensitive electronic equipment, so pay special attention to the daily maintenance of hearing aids:

- A professional examination and hearing test should be carried out before fitting hearing aids, and the use should be under the guidance of a doctor or a professional fitting of hearing aids.
- Do not allow others to use your hearing aid.
- Do not immerse the hearing aid in any liquid. Remove the hearing aid before swimming and washing your hair. After swimming or washing, wait for the ear canal to dry before putting on your hearing aid.
- The function and volume control switch should be used correctly, and the switch should be opened and closed as gently as possible to avoid excessive and excessive force.
- Hearing aids should be regularly sent to the fitting center for maintenance and inspection to ensure that they are in good condition.
- Some small parts of hearing aids can become loose due to improper use or handling. If they fall into the ear, seek medical attention immediately.

- Do not wear hearing AIDS to areas with gas leaks, or enter X-ray or MRI treatment rooms.
- In mining areas or explosive situations, please turn off the hearing aid and use it only after confirming that there is no hazard.
- The outer surface of the hearing aid should be kept clean, and the earwax in the leaf should be cleaned regularly.
- Faulty hearing aids must be repaired by qualified professional maintenance personnel. Do not disassemble or dispose them without authorization, otherwise the warranty is invalid. If there is a problem with your hearing aid, contact your fitting or manufacturer. Frequent maintenance of hearing aids by an auditor can reduce the amount of hearing aid maintenance.
- For hearing aids with the loudest output of more than 130dB SPL, high intensity sound output signals may cause damage to residual hearing. Please use it carefully or adjust the volume with the advice of the fitting technician.
- Your hearing aid is made of high-tech non-allergenic materials, but there is still a small possibility of skin irritation. If you experience an allergic reaction such as itching, redness, pain, inflammation, or burning in or around the ear, seek medical attention immediately.

Working condition

Temperature: -10 °C ~+40°C

Atmospheric pressure: 86~106KPa

Charging current: 19mA

Humidity: ≤80%

Charging voltage: 5V

Transportation & storage conditions

- Transportation conditions: moisture-proof, fall-proof and shock-proof
- Storage conditions: dry, clean and normal temperature

Disclaimer

Due to the continuous update of the product, the design and specifications are subject to change without notice without affecting the performance and quality of the product.

Important note

1. This product is not waterproof, please be careful not to let the product water.
2. Do not use hair spray or a hair dryer when wearing hearing aids.
3. If you do not use the product for a long time, please put it into the charging box and charge it every 1-2 months to avoid damaging the battery.